

Building wrap installed. Cut wrap 45° away from each corner or window. Do NOT cut an "x" shape.

Note:
Protecto Wrap products are designed to be covered and are therefore not UV stable - cover within four weeks of installation.

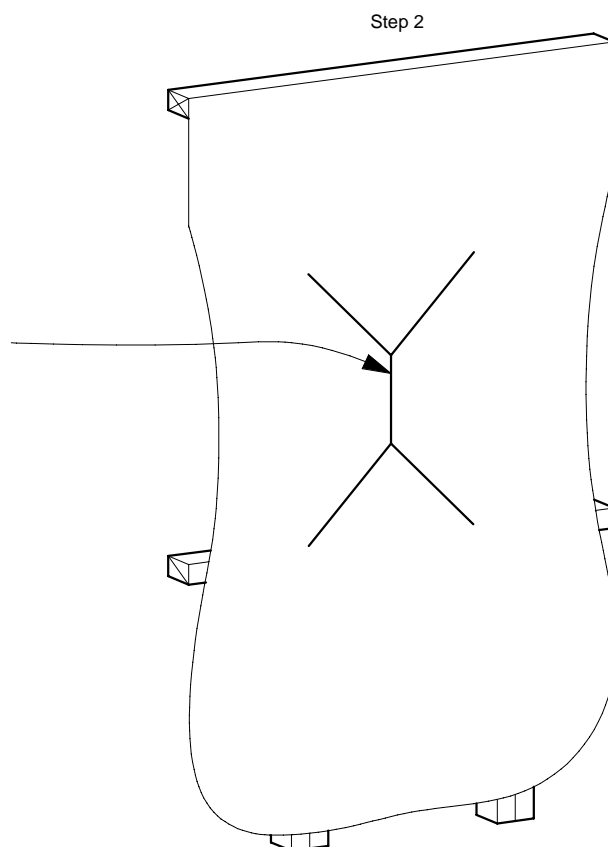

Protecto Wrap Specifiers Guide	Meter box flashing system Protecto Sill Tape - BT20XL / Detail Tape - JS500 Protecto Tape - EIFS Tape / Head Flashing Tape - BT20XL (Installation Steps) <small>Technical specification subject to change without notice</small>	CAD Ref:	PW05.1	Sheet : 05.1.2
		Date :	April 2005	
		Revision :		

Step 3

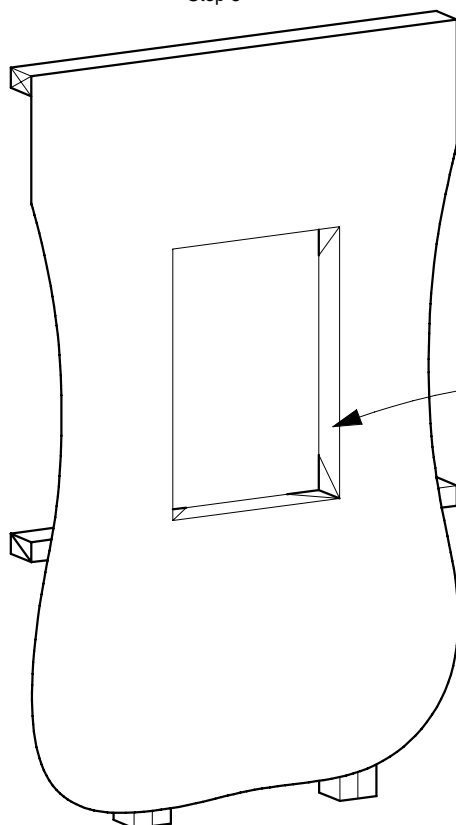

Fold wrap into opening and secure on all sides.

Step 4

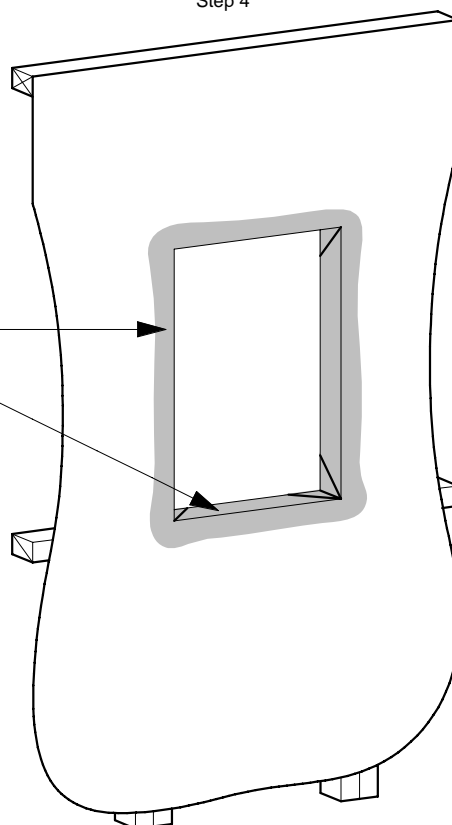

Spray Protecto Tak primer along sill, up both jambs and around the openings.

Note:
Protecto Wrap products are designed to be covered and are therefore not UV stable - cover within four weeks of installation.

Protecto Wrap Specifiers Guide	Meter box flashing system Protecto Sill Tape - BT20XL / Detail Tape - JS500 Protecto Tape - EIFS Tape / Head Flashing Tape - BT20XL (Installation Steps)	CAD Ref: PW05.1	Sheet : 05.1.3
		Date : April 2005	
		Revision :	

Technical specification subject to change without notice

Step 5

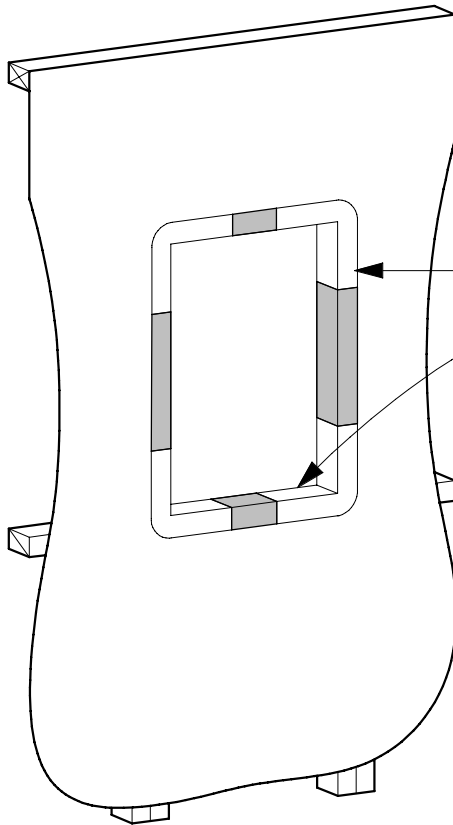

Cut 4/300mm lengths of Detail Tape - (JS500) (One piece for each corner of opening) Place 150mm of exposed membrane onto the sill /jamb junction then the remaining membrane firmly into position up the jamb. From the corner stretch and apply to outside face repeat on all four corners.

Note:
Ensure all exposed timber is covered

Step 6

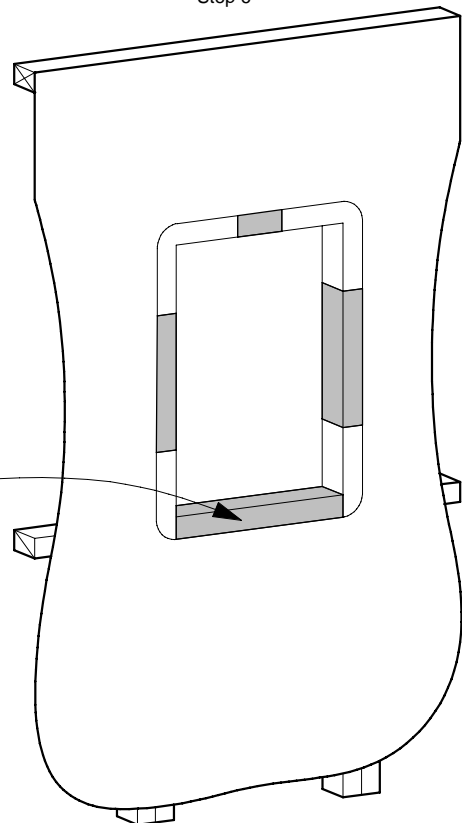

Install Protecto Sill Tape - (BT20XL) for the full length of sill. Ensure Protecto sill tape - BT20XL is fixed flush with inside edge of opening.

Note:
Protecto Wrap products are designed to be covered and are therefore not UV stable - cover within four weeks of installation.

Protecto Wrap Specifiers Guide	<p>Meter box flashing system</p> <p>Protecto Sill Tape - BT20XL / Detail Tape - JS500</p> <p>Protecto Tape - EIFS Tape / Head Flashing Tape - BT20XL</p> <p>(Installation Steps)</p> <p><small>Technical specification subject to change without notice</small></p>	CAD Ref: PW05.1	Sheet : 05.1.4
		Date : April 2005	
		Revision :	

Step 7

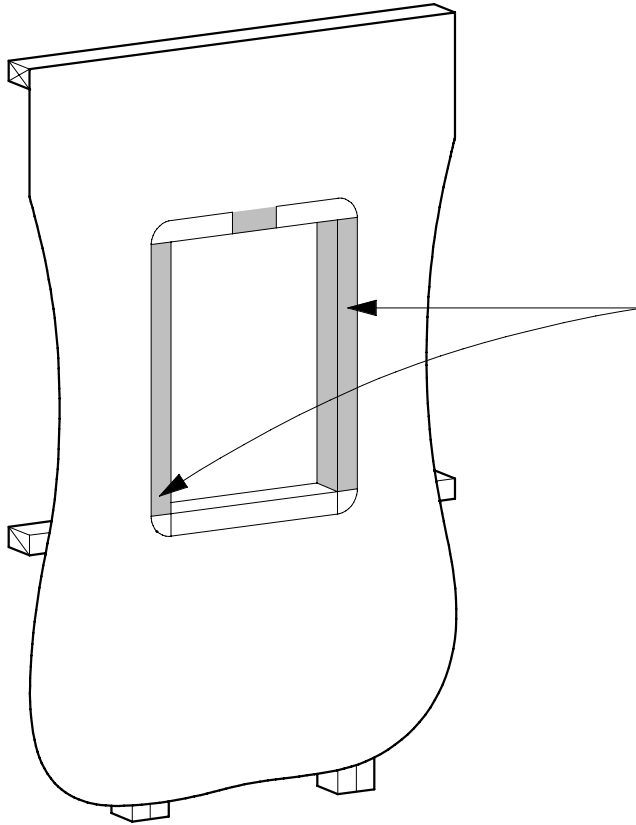

Install Protecto Sill tape - (BT20XL) to each jamb. Ensure Protecto Sill Tape - (BT20XL) is flush with inside edge of opening. Lap with Detail Tape - (JS500)

Note:

Protecto Sill Tape (BT20XL) run full height of jamb area.

Step 8

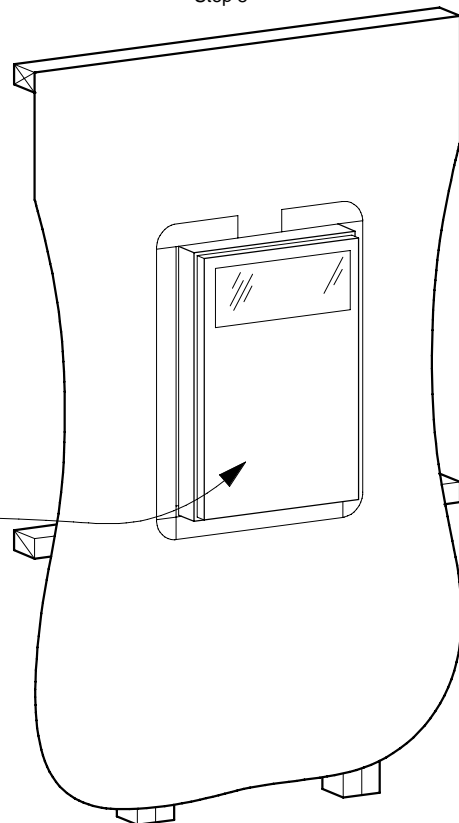

Meter board installed (By other trade)

Note:
Protecto Wrap products are designed to be covered and are therefore not UV stable - cover within four weeks of installation.

Protecto Wrap Specifiers Guide	Meter box flashing system Protecto Sill Tape - BT20XL / Detail Tape - JS500 Protecto Tape - EIFS Tape / Head Flashing Tape - BT20XL (Installation Steps) <small>Technical specification subject to change without notice</small>	CAD Ref: PW05.1	Sheet : 05.1.5
		Date : April 2005	
		Revision :	

Step 9

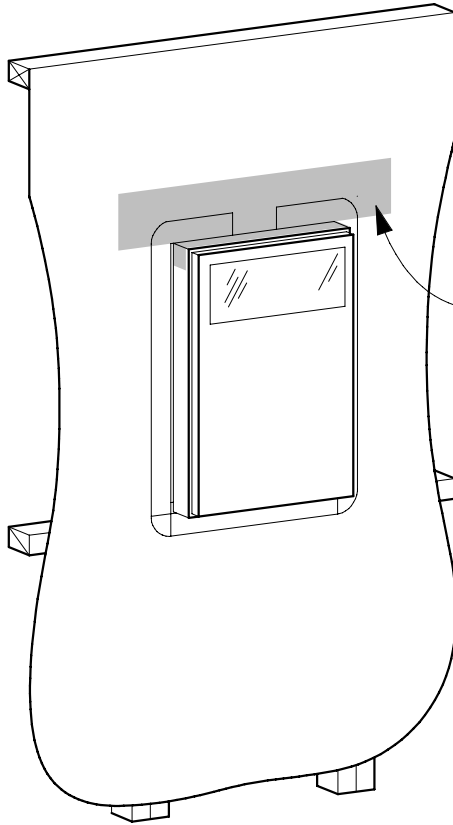

Apply a layer of spray on Protecto Tak primer to Detail Tape - (JS500), building wrap and meterbox.

Note:

Be weary of Spray Tak over spray.

Step 10

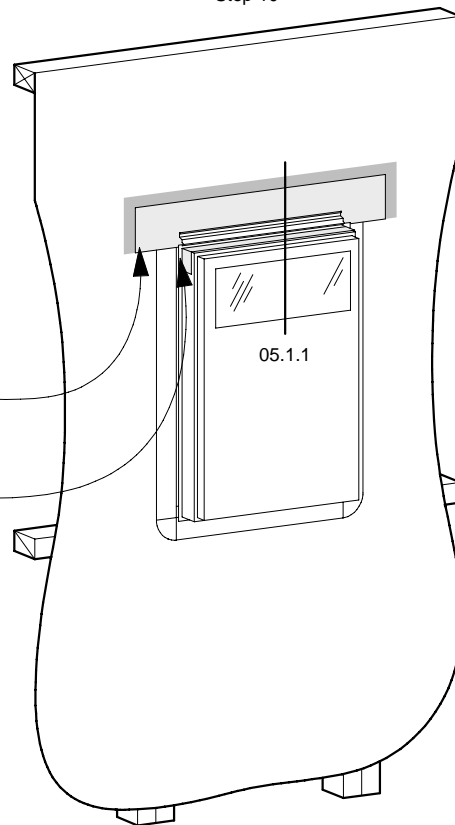

Apply Protecto Sill Tape 150mm - (BT20XL) lapping with Detail Tape - (JS500) and building wrap. Extend 50mm beyond each end of Detail Tape - (JS500) and onto meter box.

Seal and rivet angle to meterbox and to head flashing

Ready for installation of selected cladding.

Note:

Protecto Wrap products are designed to be covered and are therefore not UV stable - cover within four weeks of installation.

Protecto Wrap Specifiers Guide	Meter box flashing system Protecto Sill Tape - BT20XL / Detail Tape - JS500 Protecto Tape - EIFS Tape / Head Flashing Tape - BT20XL (Installation Steps)	CAD Ref: PW05.1	Sheet : 05.1.6
		Date : April 2005	
		Revision :	

Technical specification subject to change without notice