

step 1

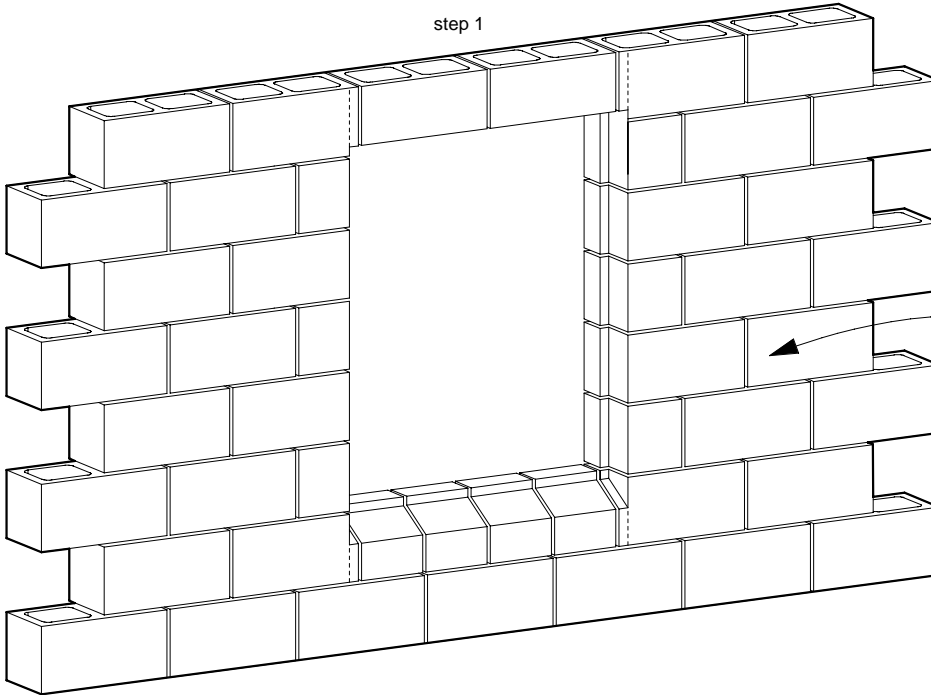

Masonry block work poly block or concrete formed walls (by other trade)

Note:

- Protecto Wrap products are designed to be covered and are therefore not UV stable - cover within four weeks of installation.
- Do not use Protecto Wrap #80 Primer on Polystyrene Block, replace with Protecto Tak Primer.

step 2

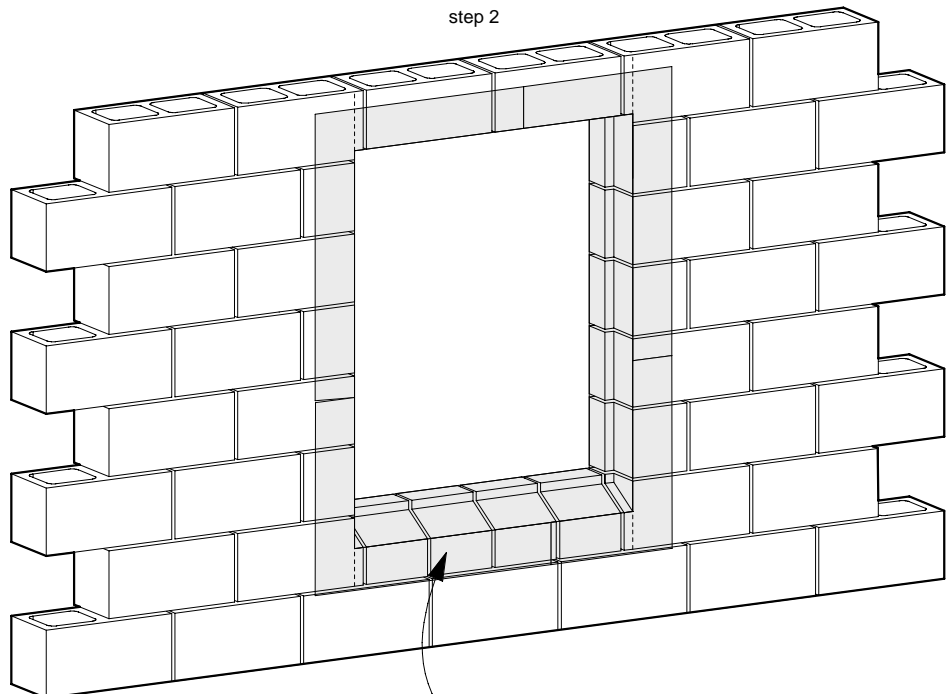

Brush or Roll Protecto Wrap #80 primer or Protecto Tak spray on Primer along sill, head and up both jambs full height.

step 3

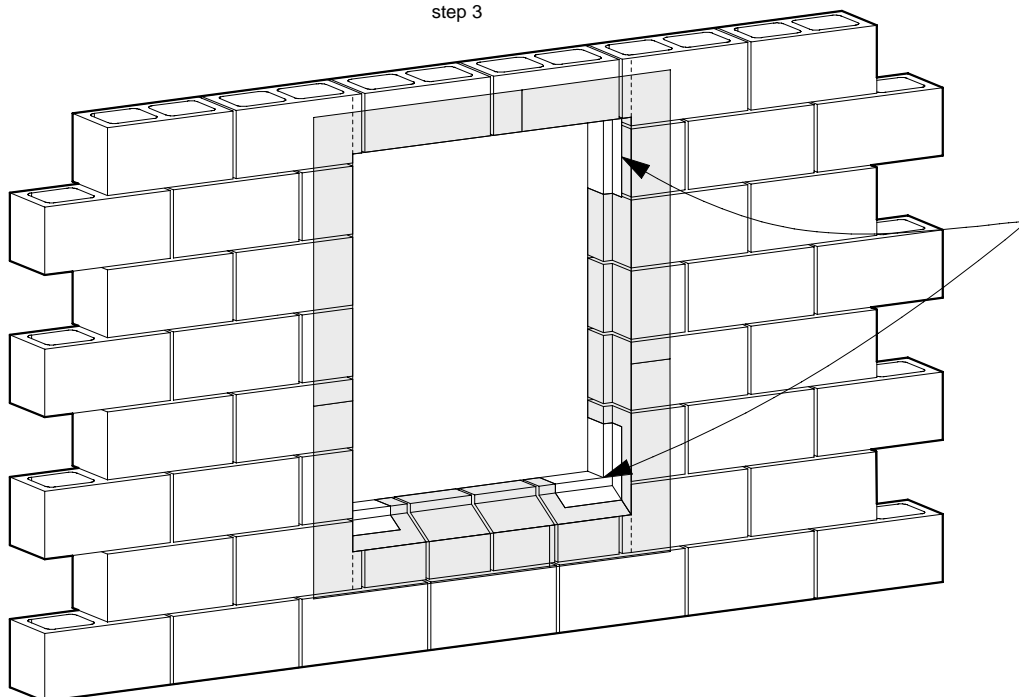

Cut 4/300mm lengths of detail tape - (JS500) (one piece for each corner of opening) Place 150mm of exposed membrane into sill and press firmly into the sill/jamb junction then the remaining membrane firmly into position up the jamb, from the corner stretch and apply to outside face. Repeat on all four corners.

Note:

- Protecto Wrap products are designed to be covered and are therefore not UV stable - cover within four weeks of installation.
- Do not use #80 Primer on polystyrene replace with Protecto Tak Primer

step 4

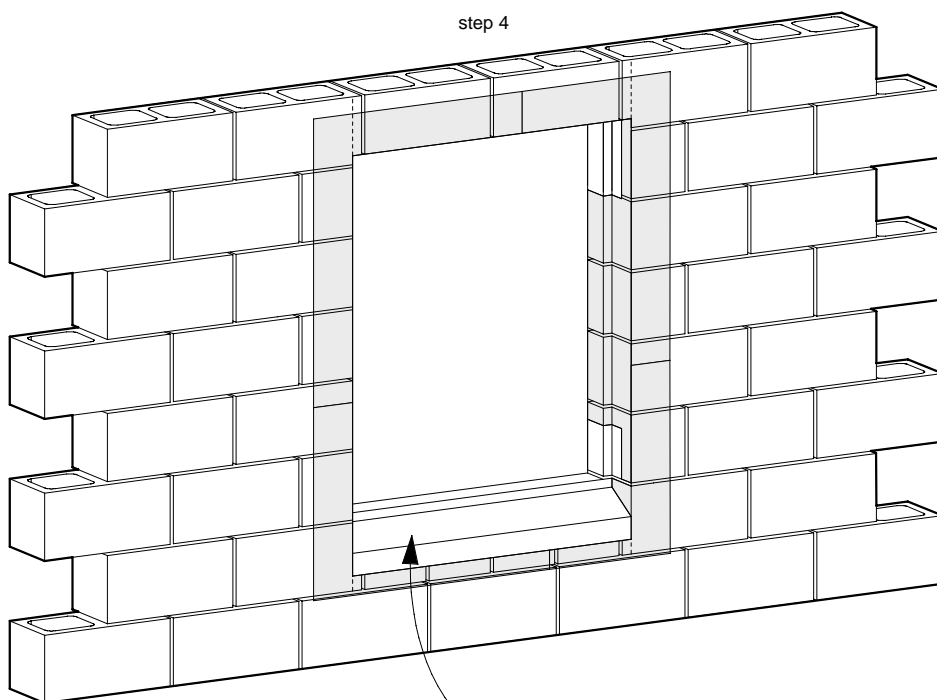

Install Protecto tape - (EIFS tape) for full length of sill ensure tape is fixed flush with inside edge of window opening. Fold Protecto tape - (EIFS tape) to front face of block work.

Protecto Wrap Specifiers Guide	Window Flashing System Detail Tape - JS500 Protecto Tape - EIFS Tape (Installation Steps) <small>Technical specification subject to change without notice</small>	CAD Ref:	PW02.3	Sheet : 02.3.5
		Date :	April 2005	
		Revision :		

step 5

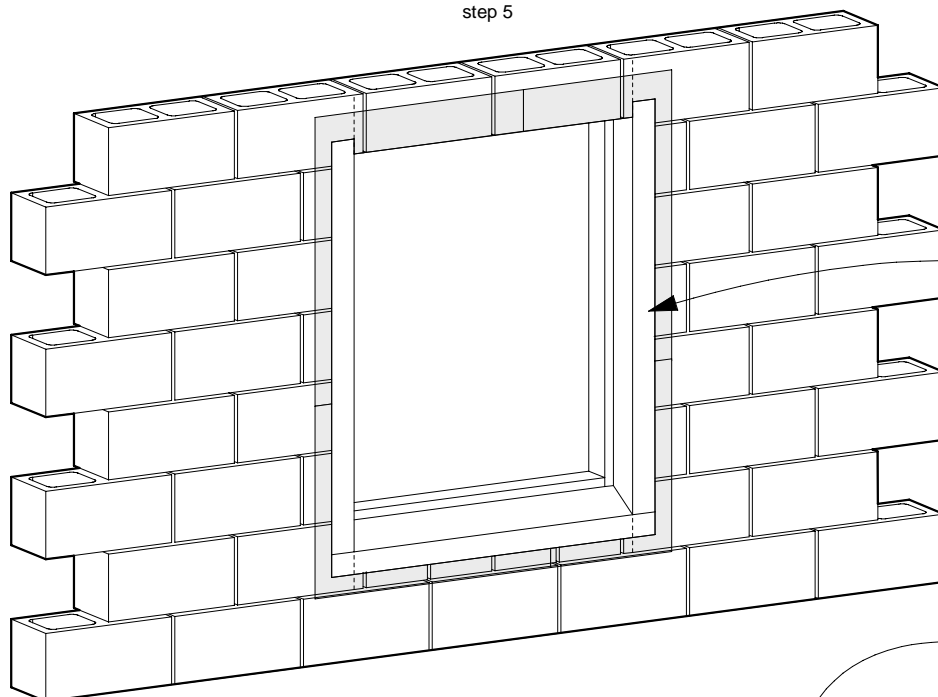

Install Protecto tape - (EIFS tape) to each jamb extending full height above sill block. Install tape flush with inside edge of window opening.

Note:

- Protecto Wrap products are designed to be covered and are therefore not UV stable - cover within four weeks of installation.
- Do not use #80 Primer on polystyrene replace with Protecto Tak Primer

Install Protecto tape - (EIFS tape) for full length of head. Ensure tape is fixed flush with inside edge of window opening.

step 6

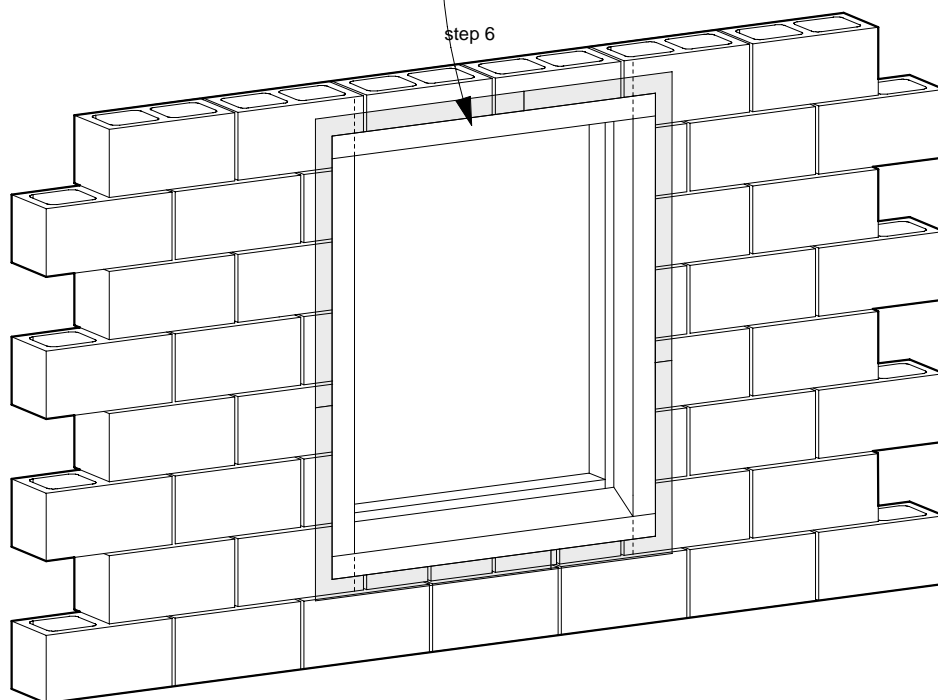

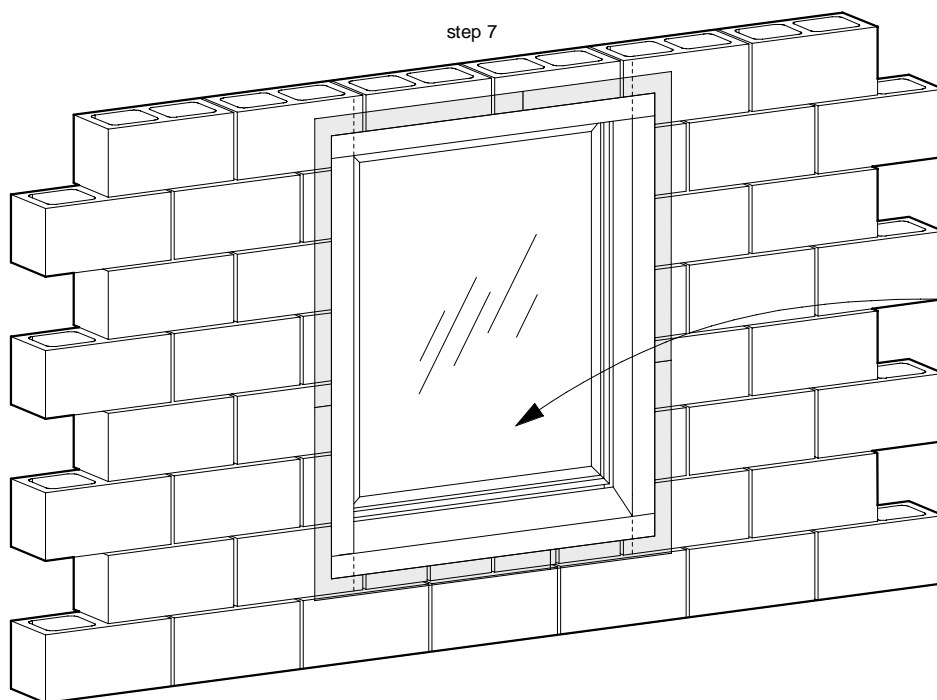

step 7

Window to be installed
(By other trade)

Note:

- Protecto Wrap products are designed to be covered and are therefore not UV stable - cover within four weeks of installation.
- Do not use #80 Primer on polystyrene replace with Protecto Tak Primer

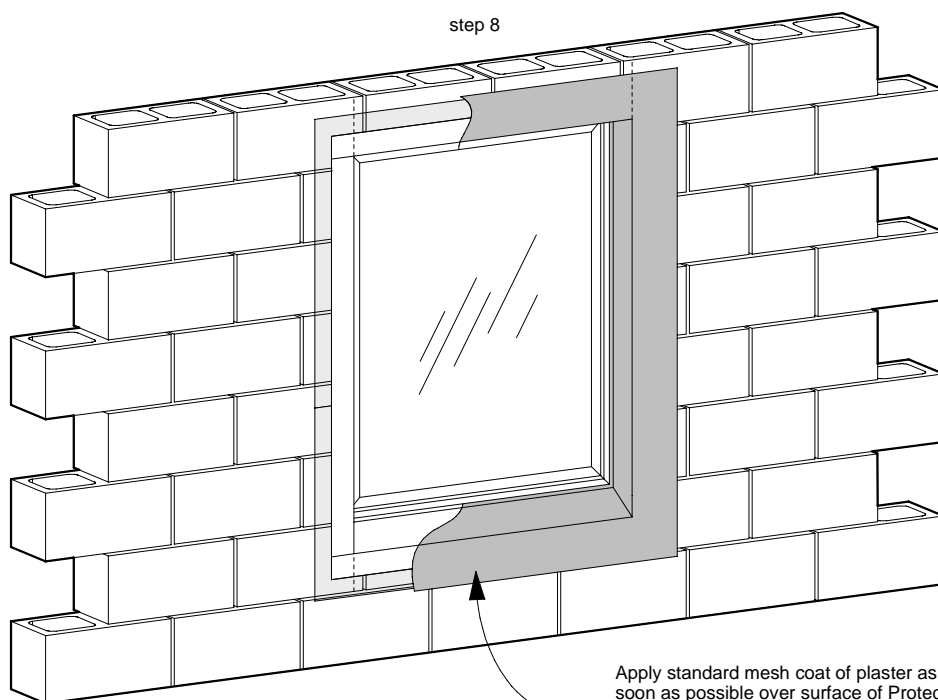

step 8

Apply standard mesh coat of plaster as soon as possible over surface of Protecto tape - EIFS tape after installation. Extend 50mm beyond extent of Protecto tape - (EIFS tape)

Protecto Wrap Specifiers Guide	Window Flashing System Detail Tape - JS500 Protecto Tape - EIFS Tape (Installation Steps) <small>Technical specification subject to change without notice</small>	CAD Ref:	PW02.3	Sheet : 02.3.7
		Date :	April 2005	
		Revision :		

step 9

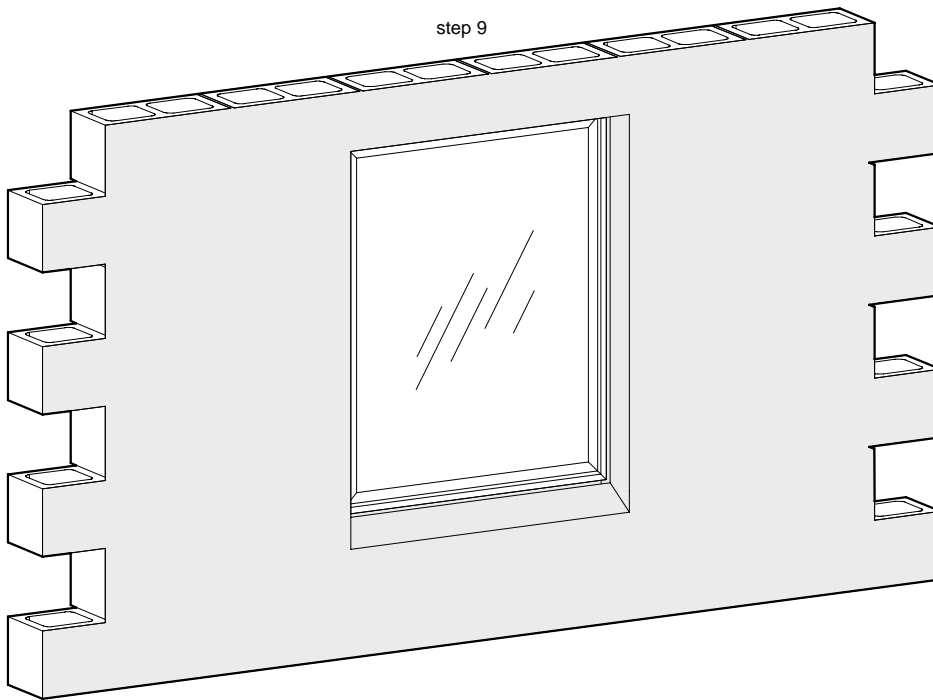

Selected 3 coat texture coating
(by other trade)

Note:
Protecto Wrap products are designed to
be covered and are therefore not UV
stable - cover within four weeks of
installation.

step 10

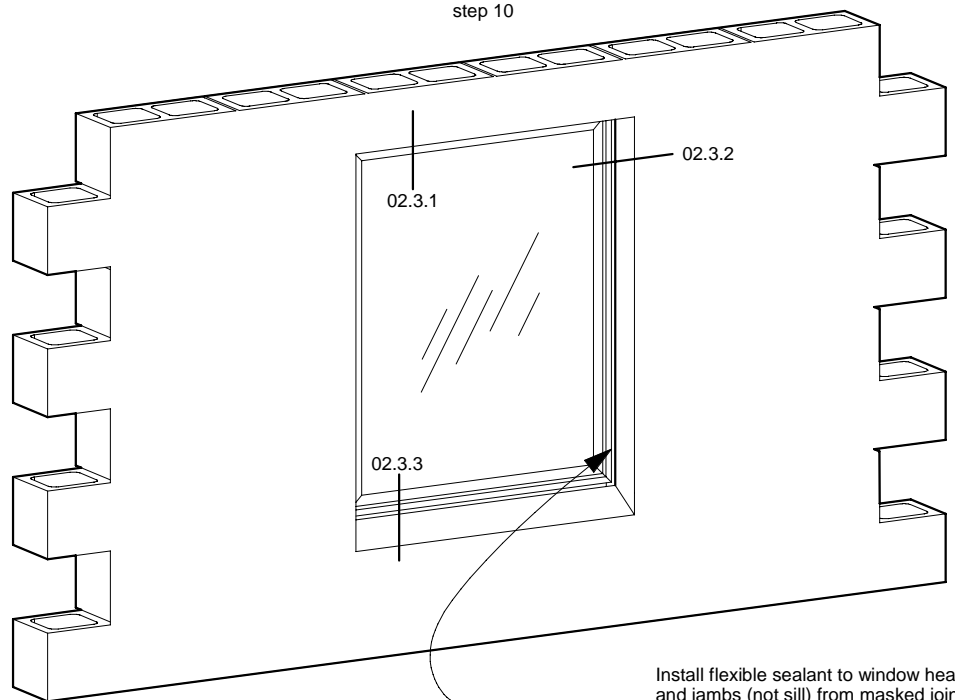

Install flexible sealant to window head
and jambs (not sill) from masked joinery
unit to finished plaster surface. Refer to
details.

Note:
Sealant must not come into direct contact
with Protecto Tape

Protecto Wrap Specifiers Guide	Window Flashing System Detail Tape - JS500 Protecto Tape - EIFS Tape (Installation Steps) <small>Technical specification subject to change without notice</small>	CAD Ref:	PW02.3	Sheet : 02.3.8
		Date :	April 2005	
		Revision :		