

DRAINAGE BOARD



Marshall
Waterproofing
Professional Solutions

Pro-Drain 8

The protection board that creates a neutral pressure zone between the foundation wall and subsoil.

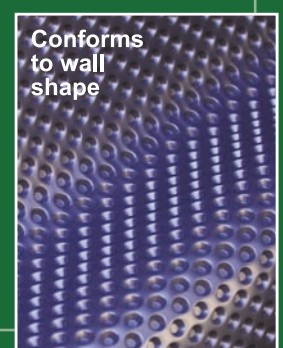
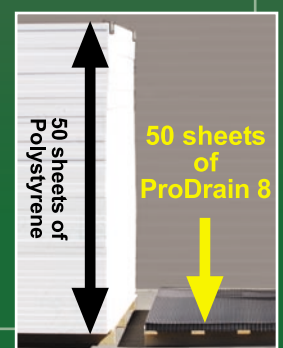
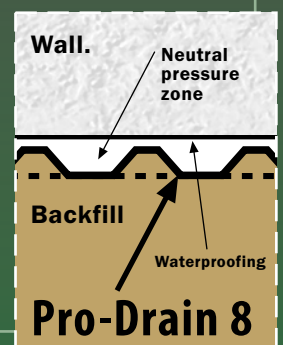

The protection board that creates a neutral pressure zone between the foundation wall waterproofing and subsoil. Can be used as protection for all foundation waterproofing systems and behind timber retaining walls.

Pro-Drain 8

1.2m x 2.1m Sheets

Installation Instruction *(Step by step guide)*

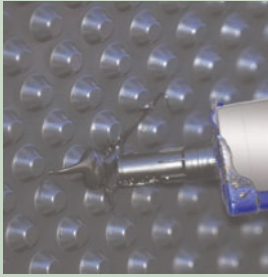

To hold sheets in place, apply adhesive to raised dimples.



Spray Tak Primer can also be used. Check compatibility with substrate.

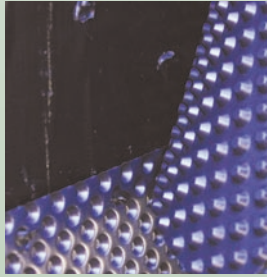

Place dimples against wall surface. Sheets can be laid horizontally or vertically.



To join sheets apply neutral cure adhesive to dimple holes. Overlap sheets by 2 dimples and press into adhesive.



OPTIONAL: Top edge can be sealed using Tak Primer and Protecto Tape to stop foreign material falling into cavity.

BUILDING CODE

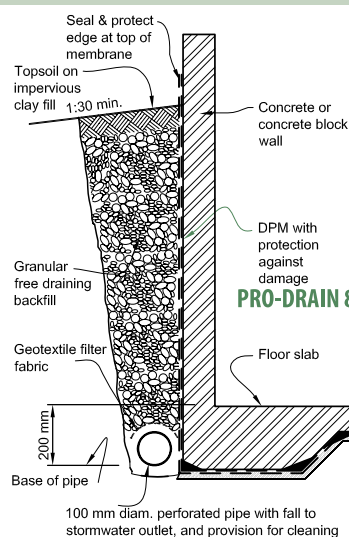

Protecto Tak Primer/Adhesive

369gr aerosol

A spray on primer/adhesive, coloured blue for easy identification.



Protecto Tape

30mtr Rolls

Protecto Tape has a fabric top that accepts plaster.

To Adhere Sheets to waterproofing substrate:

Use neutral cure high tack adhesive.

Plaster or apply water based paint over Protecto Tape within 6 weeks of installation.

benefits of pro-drain 8 foundation protection

- LIGHTWEIGHT AND COMPACT, MAKING IT EASY TO TRANSPORT, STORE AND INSTALL
- CLOSE DIMPLE SPACING PROVIDES HIGH COMPRESSIVE STRENGTH AND STABILITY
- EXTREMELY DURABLE, ROT-PROOF
- SUPERIOR SOLUTION FOR THE PROTECTION OF ALL BELOW GROUND WATERPROOFING METHODS

please note:

- Pro-Drain dimpled sheets are resistant to a wide range of chemicals, impervious to root penetration, rot-proof and unaffected by soil bacteria and fungi.
- Superior, cost effective solution for builders.
- Sheets join together, overlapping two rows of dimples.
- Sheet size: 2100mm x 1200mm.
- Water pressure from the soil is kept away from the waterproofing.
- Will conform to curved walls.
- Check compatibility of all products before application.
- Marshall Waterproofing have certified installers. Phone 0800 776 9727 for one near you.

other professional solutions by Marshall Waterproofing

- Tekton House Wrap - Building wrap of the future, BRANZ Appraisal # 548 (2007).
- Protecto Sill System - Window and door protection, BRANZ Appraisal # 444 (2005).
- Protecto Tape - Parapet and handrail protection, BRANZ Appraisal #450 (2005).
- Anti Fracture Membrane (AFM) - crack suppression and waterproofing for under tiles. Interior BRANZ Appraisal # 461 (2005). Exterior BRANZ Appraisal # 449 (2005).
- Protecto Wall - Tanking and below ground applications, BRANZ Appraisal # 517 (2006).
- Pro-Joist - Cantilevered deck joist protection, BRANZ Appraisal #497 (2006).

Aug 2007