

# SADDLE FLASHING



## Pro-Joist

Designed to flash cantilevered timber joists 47mm or 94mm thick, 250mm depth and smaller.



**Marshall**  
Waterproofing  
*Professional Solutions*

15  
year  
warranty





## Installation of Saddle Flashing

### (Step by step guide)

1. When using monolithic cladding ensure the H3.1 treated cavity battens are installed and frame the joists to be flashed.
2. Site the saddle flashing in position against the cavity battens and mark the outer edge of the flashing on the joist. Remove the flashing and apply a bead of Fix All High Tack sealant/adhesive 20mm back from this mark.

Trim the flashing to the correct depth.

3. Drive a galvanised clout either side of the flashing as shown in the diagram through the flange 15mm from the front edge.

4. Before installing the cladding which is cut to fit around the SF, ensure the perimeter weather seal of the SF is folded back onto itself allowing it to naturally spring up against the cladding as it is installed.

5. Once the cladding is in place, cut treated timber scribes to conceal any visible flashing making sure top and bottom is concealed, or paint any visible flashing with Adhesion Primer and two top coats. This will ensure the SF will not suffer adverse environmental damage and deterioration over time.

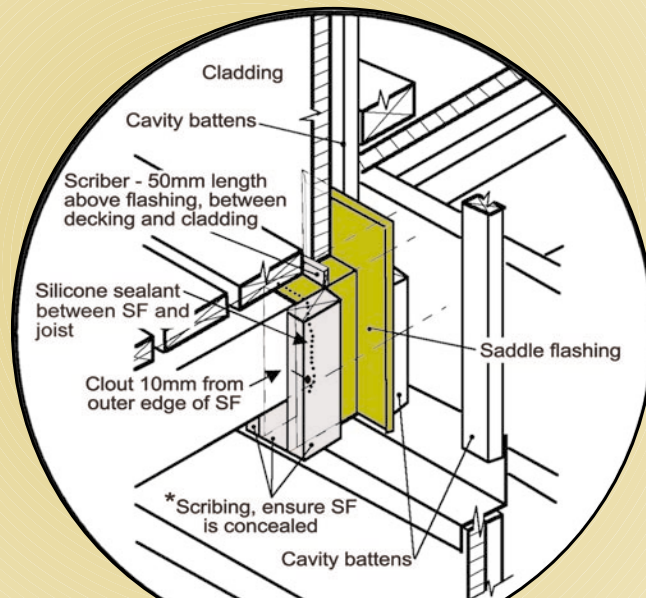
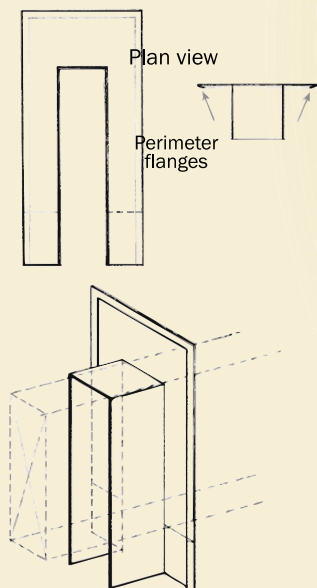

#### IMPORTANT!

\*Once the Evadry Saddle Flashing (SF) has been fitted and the cladding has been installed, attach scribing as shown in the diagram to completely conceal each flashing from ultra violet rays. Alternatively use Waterborne smooth surface sealer (Adhesion primer) and a minimum of 2 exterior top coats on visible (SF). This will ensure that the flashing will always function at its optimal level.

## benefits of pro-joist saddle flashing

- SADDLE FLASHING YOU CAN CUT TO LENGTH ON SITE
- RELIABLE, DURABLE, COST EFFECTIVE SADDLE FLASHING
- NO LAPS, JOINS OR RIVET HOLES
- TROUBLE FREE - WILL NOT CRACK OR CORRODE
- BRANZ APPRAISED - Appraisal # 497 (2006)
- 15 YEAR WARRANTY

### please note:

- A correctly installed Evadry saddle flashing (SF) will give you trouble free watertightness for the life of the building.
- Superior, cost effective solution for builders.
- BRANZ Appraised - Appraisal # 497 (2006).
- No laps, joins or rivet holes.
- Designed to fit 47mm or 94mm width x 250mm deep and smaller. There are marks indicating where to cut.
- Water penetrates a cladding. It is a role of the saddle flashing as a secondary line of defense to control the moisture and redirect it to the exterior without contacting internal framing timbers.
- The key to the success of this design are the perimeter flanges that spring back firm against the inside of the cladding.
- The durable, one piece UV stabilised polypropylene construction which has no laps, joins or rivet holes will not rot, crack or corrode.

## other professional solutions by Marshall Waterproofing

- Tekton House Wrap - Building wrap of the future, BRANZ Appraisal # 548 (2007).
- Protecto Sill System - Window and door protection, BRANZ Appraisal # 444 (2005).
- Protecto Tape - Parapet and handrail protection, BRANZ Appraisal #450 (2005).
- Anti Fracture Membrane (AFM) - crack suppression and waterproofing for under tiles. Interior BRANZ Appraisal # 461 (2005). Exterior BRANZ Appraisal # 449 (2005).
- Protecto Wall - Tanking and below ground applications, BRANZ Appraisal # 517 (2006).
- Pro-Drain 8 - The protection board that creates a neutral pressure zone between the foundation wall and subsoil.